



**PROTEA HOTEL
WITBANK**

GATEWAY TO THE EAST.



CONTENTS

LOCATION	5
INTRODUCTION	7
CONFERENCING	9
DAY CONFERENCE PACKAGES	11
VENUE SET-UP	12
CONFERENCE ROOM SPECIFICATIONS	13
FLOOR PLANS	14
SITE MAP	?
ACCOMMODATION	17
FACILITIES	19



LOCATION

Located on the outskirts of the eMalahleni (Witbank) central business district and a stone's throw from the town's shopping centers and government buildings, Protea Hotel Witbank offers comfortable accommodation, a sparkling pool, lush gardens, restaurant and bar.

GPS : -25.880201,29.219157

O.R. Tambo International Airport 120km 180min

DIRECTIONS FROM THE AIRPORT:

Head southwest on O. R. Tambo Airport Road, slight left, slight right, take the R21 ramp on the right to Boksburg, keep right at the fork and merge onto R21, At the interchange 429 Rietfontein, keep left and follow signs for N12 toward Witbank, turn right onto R555, continue onto Provincial Road. Turn right onto Price Street/R544. Continue to follow R544. Take the 1st left onto Jellicoe Street , slight left onto Beatty Avenue, Protea Hotel Witbank, 167 Jellicoe Street, Emalahleni 1035.



INTRODUCTION

This fine hotel lies on the outskirts of the eMalahleni (Witbank) CBD, a stone's throw from the town's shopping centers and government buildings. Protea Hotel Witbank offers relaxed and comfortable accommodations and is conveniently located an hour from O.R. Tambo International Airport and Pretoria on the N12 and N4, respectively. The hotel is within easy reach of the N4, the gateway to the Mpumalanga lowveld and Mozambique, and is the ideal stopover for travellers en route to the Kruger National Park or the Limpopo Province. It's a hotel that complements your travel style. Enjoy daily buffet breakfasts and dinners in our Ilanga Restaurant, or chill out in our Barristers Bar with a drink and light pub meal. Enjoy our lush garden, lounge beside the sparkling pool or make the most of the sporting facilities around the hotel.



CONFERRNCING

PROTEA ROOM

Our largest conference room is the Protea room which accommodates up to 300 delegates in theatre style. For a more relaxed function the venue can accommodate up to 200 for any banqueting events with a personalised space for tea breaks or buffet set up. This beautiful and spacious facility is suitable for any type of occasion, presentations or conferencing as it has a built in dance floor with the measurements of 48 square meters. Note pads, pens, data projectors and flip charts are all the standard equipment that is made available for you on the day.

OTHER CONFERENCE FACILITIES

Other conference facilities include Cosmos, Jacaranda, Mclachlan, Streletzia and Kiepersol.

- Cosmos room – can seat up to a maximum of 200 delegates
 - Jacaranda room – can seat up to a maximum of 50 delegates
 - Mclachlan room – can seat up to a maximum of 40 delegates
- Both Jacaranda and Mclachlan have their own private outside patio area for a relaxed break away.
- Streletzia room – can seat up to a maximum of 50 delegates
 - Kiepersol room – can seat up to a maximum of 40 delegates

CONFERENCE FACILITIES SUMMARY

- Air-conditioning
- Complimentary 500MB wireless internet
- Themed tea breaks suitable for the function
- All visual equipment
- Business centre
- Break away rooms
- Beautiful garden area for team building.



DAY CONFERENCE PACKAGES

FULL DAY CONFERENCE

OUR FULL DAY CONFERENCE PACKAGE CONSIST OF THE FOLLOWING:

- The venue hire with all the basic equipment
- 3 x tea, coffee breaks with different options of snacks
- Buffet lunch in the Ilanga Restaurant
- Vivreau bottled water, iced tea, sweets, note pads and pens and name cards

HALF DAY CONFERENCE

OUR HALF DAY CONFERENCE PACKAGE INCLUDES THE FOLLOWING:

- The venue hire with all basic equipment
- A choice of 1 or 2 x tea, coffee break with different options of snacks
- Buffet lunch on request in the Ilanga Restaurant
- Vivreau bottled water, iced tea, sweets, note pads and pens and name cards

STANDARD EQUIPMENT

THE STANDARD EQUIPMENT THAT WE OFFER INCLUDES THE FOLLOWING:

- Data projector
- Flip charts with marker pens
- Drop down screens
- AV equipment when available
- Podium

VENUE SET UP



CONFERENCE ROOM SPECIFICATIONS

ROOM	AREA IN SQM	ROOM WIDTH (M)	ROOM LENGTH (M)	THEATRE / CINEMA (PAX)	SCHOOL ROOM (PAX)	BANQUET ROUND (PAX)	U-SHAPE (PAX)
McLachlan	57.8125 m ²	6.25 m	9.25 m	40	30	40	25
Cosmos	244.125 m ²	15.75 m	15.5 m	200	120	150	80
Streletzia	90.24 m ²	9.4 m	9.6 m	50	35	60	35
Kiepersol	55.48 m ²	7.6 m	7.3 m	40	30	40	25
Jacaranda	58.85 m ²	5.5 m	10.7 m	50	40	50	35
Protea	240.6375 m ²	13.95 m	17.25 m	300	200	200	180

FLOOR PLANS

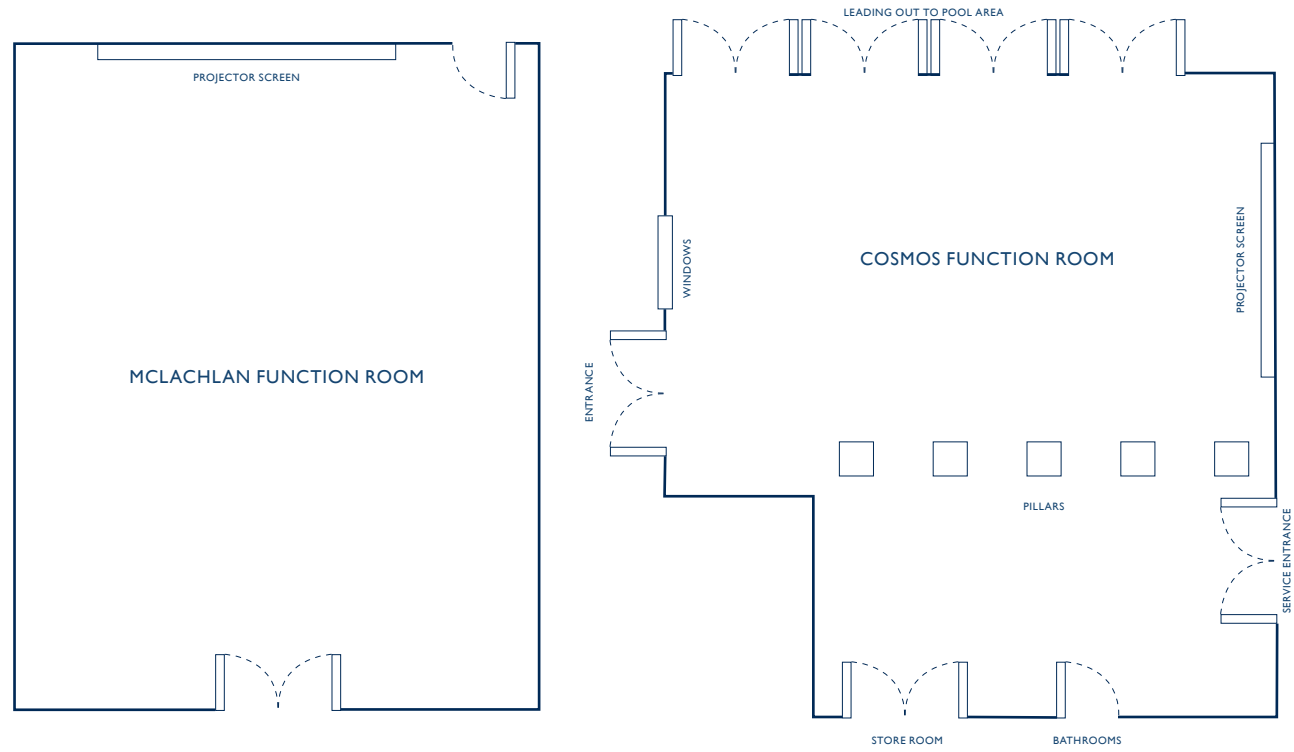

FLOOR PLANS

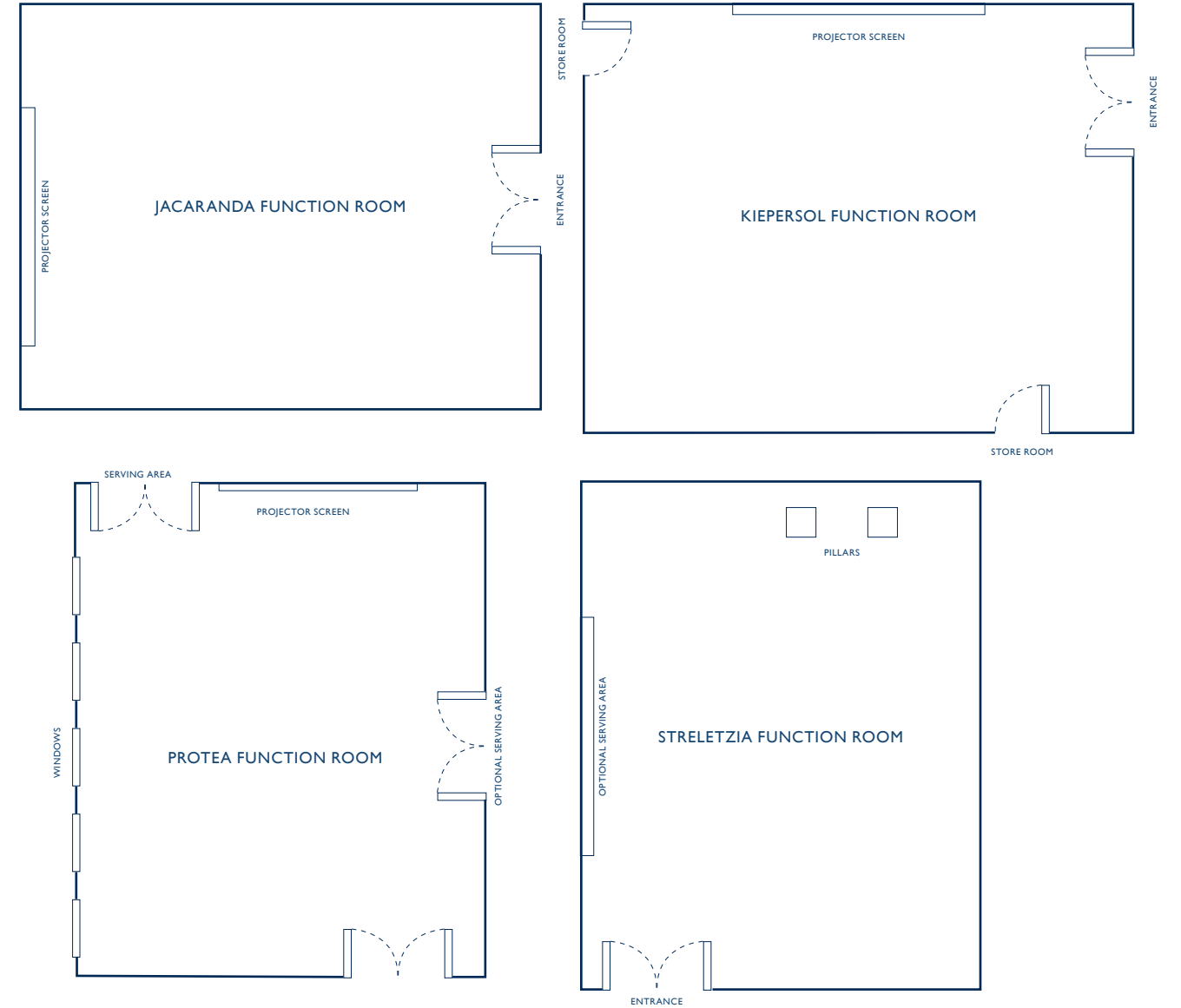



ACCOMMODATION

Protea Hotel Witbank provides 101 elegant, spacious and comfortable rooms and suites, each of which has an en-suite bathroom. All accommodation is equipped with the facilities you require to enjoy a luxurious stay. The hotel has a variety of room configurations to suite your individual needs, including 14 semi self-catering garden apartments with a separated lounge area.

STANDARD (80)

This room type is perfect for any traveling GUEST looking for comfortable accommodation with a queen size bed and private en-suite bathroom. All standard rooms are equipped with tea and coffee making facilities, hairdryers, universal plugs, electronic safes, flat screen LCD television with a selection of DSTV channels and individually controlled air conditioning. There is free 500MB Wi-Fi available per room per day for the GUESTS.

EXECUTIVE SUITES (3)

This room type is ideal for the businessman as well as honeymoon couples as it is very spacious with a king size bed and a jet bath and shower accompanied by his and her wash up areas. Unwind after a busy day on the comfortable couches provided in the lounge area. All the executive suites are equipped with an espresso machine and complimentary espresso capsules for each day, a bar fridge (not stocked), hairdryers, universal plugs, electronic safes, flat screen LCD television with a selection of DSTV channels and individually controlled air conditioning. There is free 500MB Wi-Fi available per room per day for the GUESTS.

JUNIOR SUITES (3)

This room type with its separated lounge area and very spacious room make it ideal for a longer staying GUEST to experience a comfortable stay. The room is equipped with tea and coffee making facilities, hairdryers, universal plugs, electronic safes, flat screen LCD television with a selection of DSTV channels, individually controlled air conditioning and 500MB Wi-Fi per day.

GARDEN APARTMENT (14)

Feel at home in our spacious garden apartments with a separate lounge and en-suite bathroom with a shower and a corner bath. Each garden apartment can be associated with a semi self-catering room as it has its own kitchenette and mini bar fridge. All garden apartments have their own entrance separated from the other hotel rooms and are equipped with tea and coffee making facilities, individually controlled air conditioning, electronic safes, and flat LCD screen television with a selection of DSTV channels. We offer free 500MB per day.

UNIVERSALLY ACCESSIBLE ROOM (1)

The universally accessible room provide all features of a standard room, with a spacious bathroom to suit specialised needs. The room offers facilities such as tea and coffee making facilities, hairdryers, universal plugs, electronic safes, flat screen LCD television with a selection of DSTV channels, individually controlled air conditioning and 500MB Wi-Fi per day.

ROOM AMENITIES

Wi-Fi access, hairdryers, en-suite bathrooms (bath and shower), tea and coffee making facilities, universal plug adaptors, telephones, full back up generator, iron and ironing board on request, individually controlled air-conditioning, business desk, electronic laptop size safe, mini bar in some rooms – not stocked, LCD flat screen televisions and DSTV and a 'Welcome' note as a small token of appreciation.





FACILITIES

SPORT AND LEISURE

ON SITE

Enjoy a gym session at Planet Fitness Gym with complimentary vouchers on request.

Unwind next to the pool with friends and family.

For a more relaxed experience GUESTS can stroll through the enchanting gardens.

NEARBY

Witbank Golf Club

Puma/Atlantic Stadium

Witbank Theatre

Highveld Mall and Entertainment Centre

Paintball

Witbank Dam

Steve's Place Resort

DINING

ILANGA RESTAURANT (ON SITE)

GUESTS can enjoy exquisite buffet breakfasts and dinners in the Protea Hotel Witbank's Ilanga Restaurant daily and buffet lunch is served on request. The Barristers Bar is a great place to unwind after a long day at the office and to enjoy sundowners, a light pub meal or simply to relax. We offer an à la carte menu from 06h00 until 22h00 daily to the GUESTS. Private dining is available on request.

THE SERVING TIMES ARE AS FOLLOWS:

Breakfast is served from 06h30 until 09h30

Lunch (on request) is served from 12h00 until 14h30

Dinner is served from 18h30 until 22h00

Room service is available from 06h30 until 22h00

The Barristers Bar is open daily from 11h00 until 23h00



PROTEA HOTELS

167 Jellicoe Street, eMalahleni 1034, South Africa

Tel: +27 (0) 13 656 6424 Fax: +27 (0) 13 656 4926 Email: reservations@proteawitbank.co.za
proteahotels.com/witbank

Protea Hotels, Central Reservations South Africa

Tel: 0861 11 9000 or +27 (0) 21 430 5300 | Fax: +27 (0) 21 430 5330 | Email: reservations@proteahotels.com
proteahotels.com

Follow Protea Hotels on

